

The New St James's Hospital

733405 N

713914 E

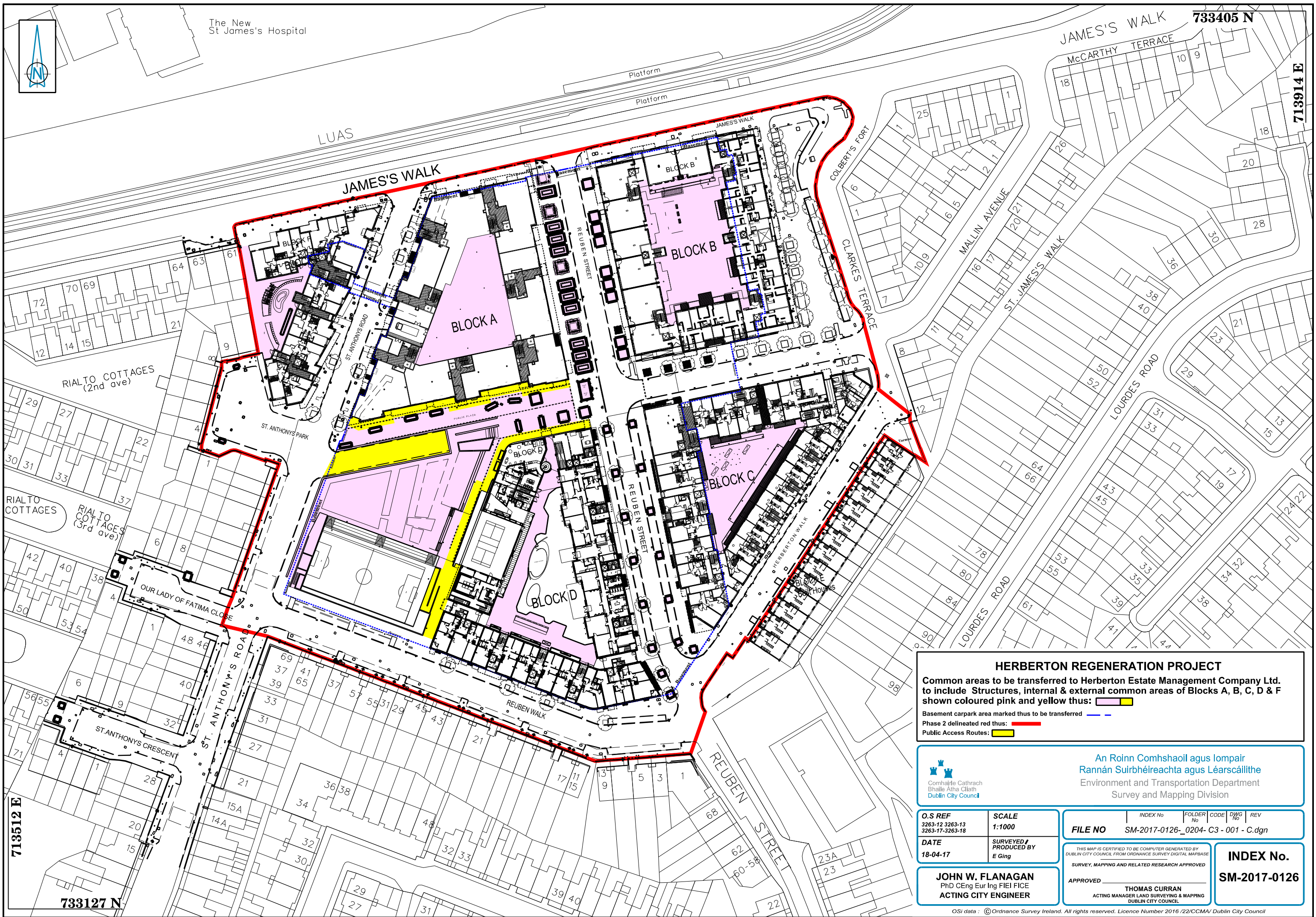

HERBERTON REGENERATION PROJECT

Common areas to be transferred to Herberton Estate Management Company Ltd. to include Structures, internal & external common areas of Blocks A, B, C, D & F shown coloured pink and yellow thus:

Basement carpark area marked thus to be transferred

Phase 2 delineated red thus:

Public Access Routes:



An Roinn Comhshaoil agus Iompair
Rannán Suirbhéireachta agus Léarscáilithe
Environment and Transportation Department
Survey and Mapping Division

O.S REF
3263-12 3263-13
3263-17-3263-18

SCALE
1:1000

INDEX No | FOLDER No | CODE | DWG No | REV
FILE NO SM-2017-0126_0204-C3-001-C.dgn

DATE
18-04-17

SURVEYED / PRODUCED BY
E Ging

THIS MAP IS CERTIFIED TO BE COMPUTER GENERATED BY DUBLIN CITY COUNCIL FROM ORDINANCE SURVEY DIGITAL MAPBASE SURVEY, MAPPING AND RELATED RESEARCH APPROVED

JOHN W. FLANAGAN
PhD CEng Eur Ing FIEI FICE
ACTING CITY ENGINEER

APPROVED
THOMAS CURRAN
ACTING MANAGER LAND SURVEYING & MAPPING
DUBLIN CITY COUNCIL

INDEX No.
SM-2017-0126

733127 N

713512 E